

NO.	FACILITY	TOP ELEVATION
27	Airport Administration Building	914.8
28	Airport Operations/Terminal	941.6
29	Paint House	912.1
30	T-Hangar No. 1 "B"	922.6
31	T-Hangar No. 2 "A"	916.5
32	T-Hangar No. 3 "A"	915.9
33	Hangar No. 4	944.8
34	Aeronautical & Astronautical Lab	921.2
35	Flight Laboratory Hangar	928.4
36	Hangar 1, 2 and 3	922.8
37	Airport Maintenance Building	925.2
38	Hangar No. E	925.6
39	Hangar No. 7	936.5
40	Worthington Ind. Hangar No. 8	954.7
41	Crash-Fire-Rescue Building	925.1
42	Hangar No. 9	951.5
43	T-Hangar No. 4 "C"	894.1
44	T-Hangar No. 5 "D"	893.7
45	FAA Air Traffic Control Tower	866.8
46	3701 Bureau of Aviation Hangar	923.0
47	Ohio National Guard Hangar	923.0
48	Ohio National Guard Storage	910.7
49	Ohio National Guard Storage	910.9
50	Agriculture	912.0
51	U. S. U. Fuel Farm	grade
52	Ohio C/A Fuel Farm	grade
53	Ohio National Guard Fuel Farm	grade
54	Barn	979.3
55	Joint Use Fire Station	922.0
56	Airport Maintenance	920.0

NO.	FACILITY	TOP ELEVATION
148	Swine Evaluation Station	910.0
201	Laboratory Animal Ctr. Bldg. 1	880.7
202	Laboratory Animal Ctr. Bldg. 2	884.0
203	Laboratory Animal Ctr. Bldg. 3	873.3
204	Laboratory Animal Ctr. Bldg. 4	855.7
286	Straw Shed	909.5
318	Sheep Barn	920.9
319	Farm Shop	923.5
320	Machine Storage	919.5
321	Feed Mill	979.7
322	Hay Storage	922.5
323	Horse Barn	940.5
324	Calf Barn	971.5
325	Cow Barn	972.5
326	Swine Barn	926.0
327	Waste Treatment	926.0
333	Range Shelter 1	921.5
334	Range Shelter 2	922.0
335	Range Shelter 3	923.0
358	Swine Station Storage Building	913.0
361	Beef Barn	909.8
957	USDA Machine Storage Building	912.4
982	Farm Science Review Building	910.2
991	Equipment Storage Building	910.2
1006	Residence	910.0
1006	Farm Building	910.0
1111	Residence	920.0

Buildings To Be Removed

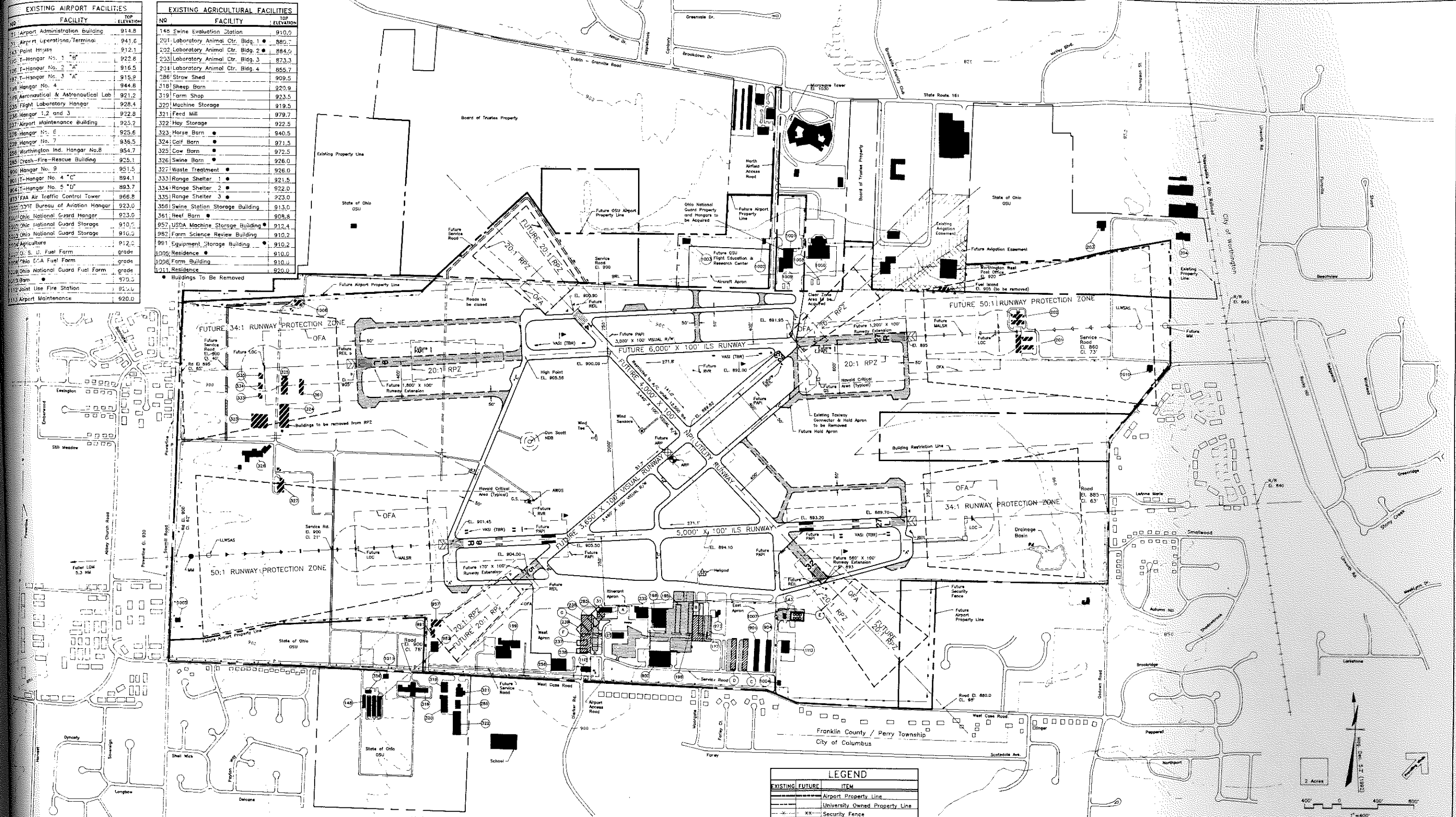

- Notes:**
1. Future structures will conform to FAA NAVAID Critical Areas, FAA Part 77 Obstruction & ATCT Line of Sight Criteria.
 2. Airport Design Standards based on FAA Class III Aircraft Design Group.
 3. Certain OSU Agricultural and Laboratory Animal Buildings are to be removed from Runway Protection Zones, and their functions are to be relocated to an off-airport site.
 4. Airport Layout Plan based on Current Aerial Photography. Before any Engineering Design or Construction Projects are undertaken the exact location of all Facilities should be field checked.
 5. Property lines shown indicate properties previously pledged under FAA grants and required for airport protection. Property lines may be altered subject to future negotiations between the sponsor and FAA.
 6. All University owned land beyond that required for Airport purposes will require Aviation Easements and assurances of land use compatibility before release from FAA Grant Assurances.

NO.	FACILITY	TOP ELEVATION
A	Airport Terminal Expansion	920
B	Corporate Hangar	950
C	15 Unit T-Hangar	900
D	15 Unit T-Hangar	900
E	Fuel Farm Expansion	895
F	FBO Maintenance Hangar	950
G	FBO Maintenance Hangar	950

EXISTING	FUTURE	ITEM
---	---	Airport Property Line
---	---	University Owned Property Line
---	---	Security Fence
---	---	Building Restriction Line
---	---	Airfield Pavement
---	---	Buildings
---	---	Railroad
---	---	Windcone
---	---	Airport Reference Point
---	---	NAVAIDS
---	---	Ground Contours
---	---	Surface Drainage
---	---	Aviation Easement
---	---	Buildings to Be Removed
---	---	Roads to be Closed
---	---	Rotating Beacon Ft. 936.6
---	---	Helipad

APPROVALS

OHIO STATE UNIVERSITY

By: _____ Date: _____

OHIO DEPARTMENT OF TRANSPORTATION

By: _____ Date: _____

FEDERAL AVIATION ADMINISTRATION

By: _____ Date: _____

DATE	REVISION

Future Airport Layout Plan

2 of 12

OHIO STATE UNIVERSITY AIRPORT
Columbus, Ohio

AVIATION PLANNING ASSOCIATES, INC.
Cincinnati, Ohio 45202

AP No. 3-39-0227-05, date: March 13, 1982

THE PREPARATION OF THIS DOCUMENT WAS FINANCED IN PART THROUGH A FUNDING GRANT FROM THE FEDERAL AVIATION ADMINISTRATION AS PROVIDED UNDER SECTION 505 OF THE AIRPORT AND AIRWAY IMPROVEMENT ACT OF 1946, AS AMENDED. THE CONTENTS DO NOT NECESSARILY REFLECT THE OFFICIAL POSITION OR POLICY OF THE FAA. ACCEPTANCE OF THIS REPORT BY THE FAA DOES NOT IN ANY WAY CONSTITUTE A COMMITMENT ON THE PART OF THE UNITED STATES TO PARTICIPATE IN ANY JOINTLY OWNED DEVELOPMENT, THEREIN OR ELSEWHERE, OR TO INCUR ANY LIABILITY OR OBLIGATION. SUCH DEVELOPMENT IS ENVIRONMENTALLY ACCEPTABLE IN ACCORDANCE WITH APPROPRIATE FEDERAL LAWS.